



Quick Start Guide

HYAMP[®]

Model 3240



SAFETY CHECKLIST

- S**urvey the test station. Make sure it is safe & orderly.
- A**lways keep unqualified/unauthorized personnel away from the test area.
- F**amiliarize yourself with safety protocols in the event of a problem.
- E**xercise caution and never touch products or connections during a test.
- T**rain operators. Never touch clips directly and always connect the return lead first.
- Y**ou should always know when a test is being performed.



WARNING: THIS GUIDE WAS CREATED FOR OPERATORS HAVING SOME FAMILIARITY WITH ELECTRICAL SAFETY TESTING. AN ELECTRICAL SAFETY TESTER PRODUCES VOLTAGES AND CURRENTS THAT CAN CAUSE HARMFUL OR FATAL ELECTRIC SHOCK. TO PREVENT ACCIDENTAL INJURY OR DEATH, THESE SAFETY PROCEDURES MUST BE STRICTLY OBSERVED WHEN HANDLING AND USING A TEST INSTRUMENT. CONTACT US AT INFO@ARISAFETY.COM FOR MORE INFO ON HOW TO GET TRAINED ON ELECTRICAL SAFETY TESTING.

INSTRUMENT SETUP



WARNING: LOCATE A SUITABLE TESTING AREA WITH A THREE-PRONG, GROUNDED OUTLET. BE SURE THAT YOUR THREE-PRONG OUTLET HAS BEEN TESTED FOR PROPER WIRING. READ THE SAFETY CHECKLIST OF THIS GUIDE BEFORE STARTING TO TEST.

Find parts for Instrument Setup in **Section 1 of your Accessory Box.**

- 1 Connect the female end of the power input plug into the rear of the instrument and plug the male end of the cord into a grounded power source.

To Grounded
Power Source



- 2 Plug the Interlock Disable Key into the signal/ input connector on the rear panel of the instrument. Instrument will not output Voltage with Interlock Disable Key unplugged.



- 3

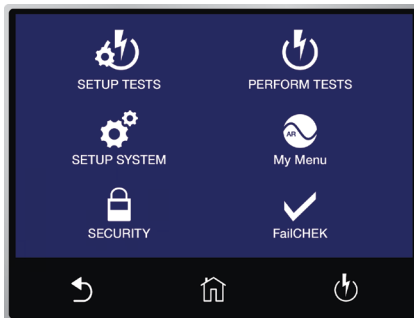

Push the POWER button to turn the instrument ON.



Home Screen

TOUCH SCREEN OPERATIONS



-  Back
-  Home
-  Test Screen



TOUCH

Tap the virtual buttons to open various functions.

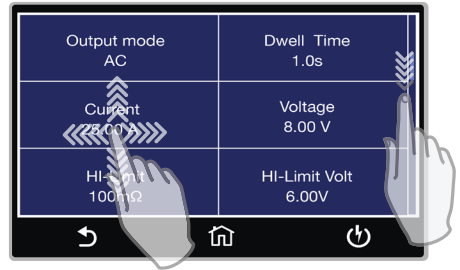

SWIPE UP, DOWN, LEFT & RIGHT

Simple swipes allow you to quickly move through screens & parameters.

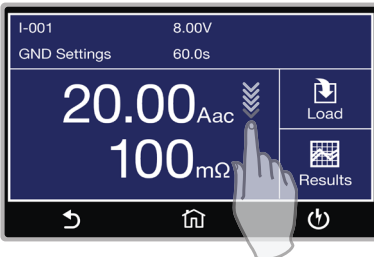

DRAG & DROP

Drag and drop meters on your Perform Test screen. Simply touch, hold, and drag meter to any of the other meter locations.



TOUCH & HOLD

Touch and hold test file or test step to show available Quick Actions: Save As, Delete, Insert, etc.

TEST SET UP



TAP SETUP TESTS
Home Screen

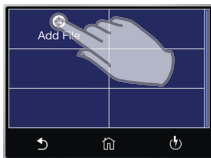

TAP ADD FILE
File Screen



ADD FILE NAME
Tap the ENTER () key to save your selection

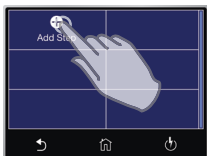

TAP ADD STEP
Add Step

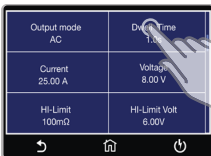

TAP TEST SETTING
Tap the test type, and the parameter you would like to edit. Swipe up and down to scroll through test parameters.

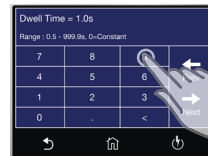

EDIT PARAMETERS
Tap parameter values to edit individually.

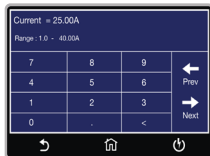

ADJUST PARAMETERS
Select Next, to continue through each parameter to adjust values based on your application.

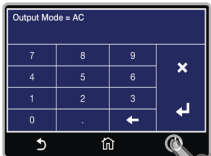

EXIT PARAMETERS
Press the Test Screen button to exit out of Parameters.

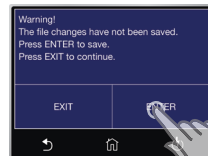

SAVE FILE CHANGES
Press ENTER to save your file changes. You will be redirected to the Test Screen.

TEST CONNECTION



WARNING: DO NOT TOUCH THE DEVICE UNDER TEST ONCE YOU START THE TEST.

Find test leads for DUT Connections in **Section 2 of your Accessory Box.**

- 1 Connect the black return test lead (P/N 38490) to the black Return terminal located on the front panel of the instrument.
- 2 Connect the black sense lead to the Sense(-) terminal located just above the Return terminal.
- 3 Clip the end of the black return test lead to the chassis ground of the DUT.
- 4 Connect the red high current test lead (P/N 38489) to the red Current terminal on the front panel of the instrument.
- 5 Connect the red high current sense lead to the red Sense(+) terminal.
- 6 Connect the red clip end of the high current test lead to the ground/earth contact of the DUT.

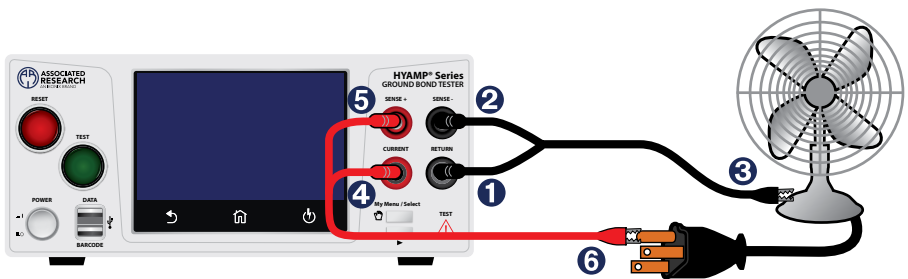

Did You Know?

The **Data** port on the front of the instrument can be used to download test results directly to a USB thumb drive.

The **Barcode** port is compatible with a USB barcode scanner so you can automatically scan product barcodes and run test sequences.



Hypot® INTERCONNECTION

INTERCONNECTION OF HYAMP® SERIES TO HYPOT® SERIES

You can interconnect a HYAMP® to all Hypot® models to form a complete test system.

- 1 Using the rear panel connections, connect the following cord:
 - a. P/N HS-8-11 - Plug one end into the rear Sense (-) terminal on the HYAMP® Ground Bond tester. Plug the other end into the Return terminal on the rear panel of the Hypot®.
 - b. P/N 39932 - Plug the blue coded end into the HYAMP Signal Input. Plug the red coded end into Hipot Signal Output.
 - c. P/N 39933 - Plug the blue coded end into the HYAMP Signal Output. Plug the red coded end into the Hipot Signal Input.

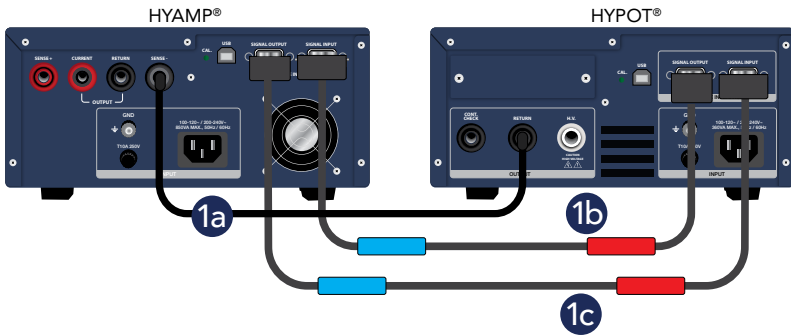

Note: Once interconnected, Hypot will disable the auto configure system settings by turning PLC on. Disconnecting the cables disables the PLC remote.

CONNECTION TO A DEVICE UNDER TEST

- 2 P/N 38490 - Plug the black return test lead into the front panel Return terminal on the HYAMP®.
- 3 Clip the end of the test lead to chassis ground of the DUT.
- 4 P/N 38482 - Plug the red high current lead of the adapter box into the front panel Current terminal on the HYAMP®.
- 5 Plug the white Alden plug into the front panel High Voltage terminal on the Hipot tester.

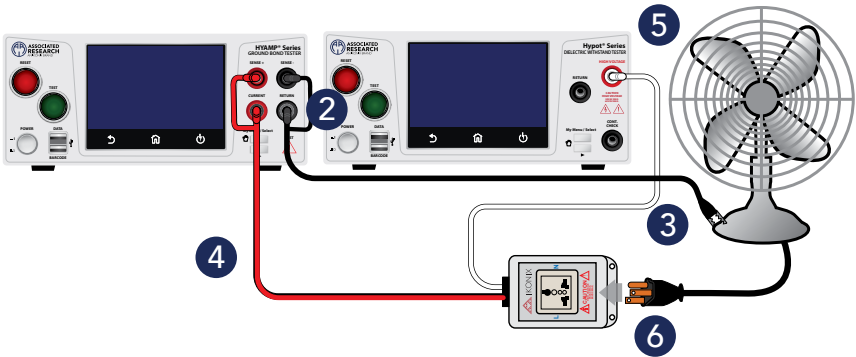

- 6 Plug the DUT line cord into the adapter box.
- 7 Once the test parameters are set, start the test from the HYAMP®.
- 8 If the Ground Bond test passes, the Hipot test will automatically start. If a test fails, the test sequence will abort and failure results are displayed.



SCAN FOR
VIDEO
LIBRARY



Experts In Electrical Safety Compliance.®



For additional information about these and other key features of the HYAMP®, please consult the full Operation and Service Manual or call us toll-free 1-800-858-TEST (8378) or +1-847-367-4077
©2022 Associated Research • arisafety.com

FOLLOW US!

